

NOTE:
 T-304 STAINLESS STEEL: FOR INTERIOR APPLICATIONS AND NON CORROSIVE ENVIRONMENTS IS RECOMMENDED.
 T-316 STAINLESS STEEL: FOR EXTERIOR APPLICATIONS WITHIN 15 MILES OF THE COAST OR IN A CORROSIVE ENVIRONMENT IS RECOMMENDED.

TOP CAP: 3" X 1" TUBE ALUMINUM TUBE.

FINISH: POWDER COAT TO THE CUSTOMER'S SPECIFICATION.

POST: 2" X 2" ALUMINUM TUBE.

***NOTE:** POST ARE SPACED EVENLY IN A GIVEN AREA @ APPROXIMATELY 48" TO 52" O/C.

API-2000 42" HIGH ALUMINUM CABLE HAND RAILING.

SCALE: 1" = 1'

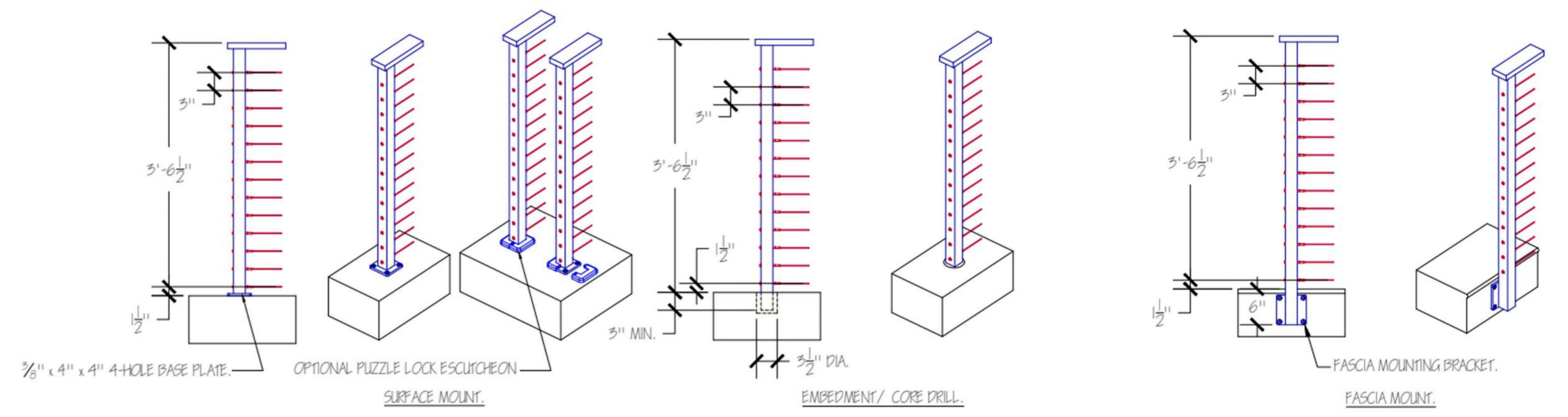

API-2000 TYPICAL MOUNTING OPTIONS.

SCALE: 3/4" = 1'

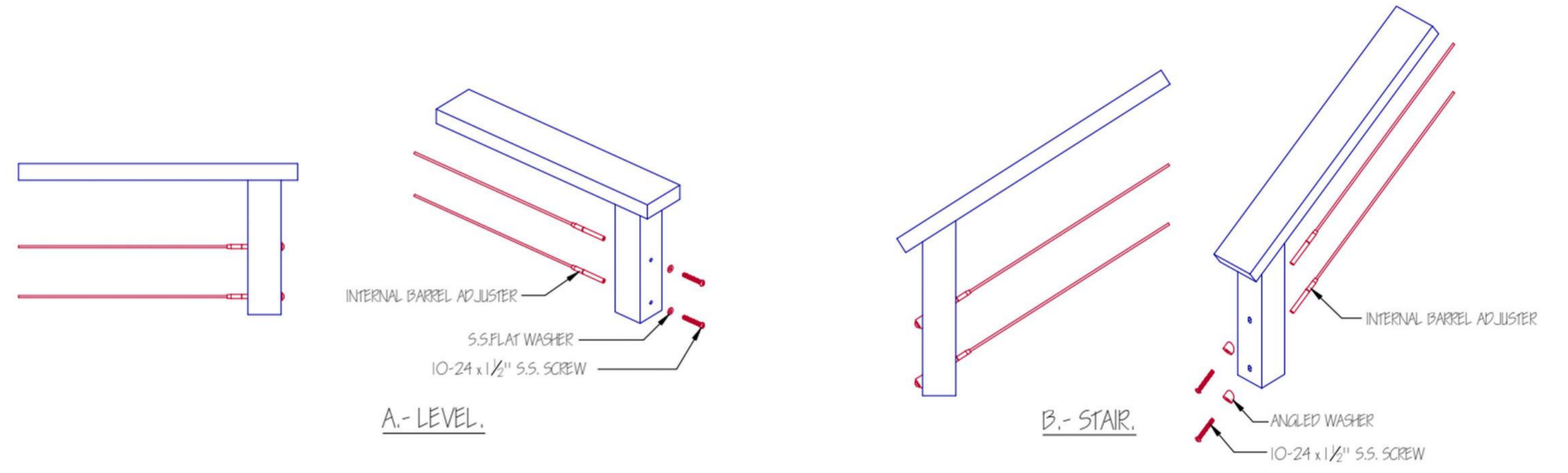

CABLE ATTACHMENT DETAIL.

SCALE: 2" = 1'

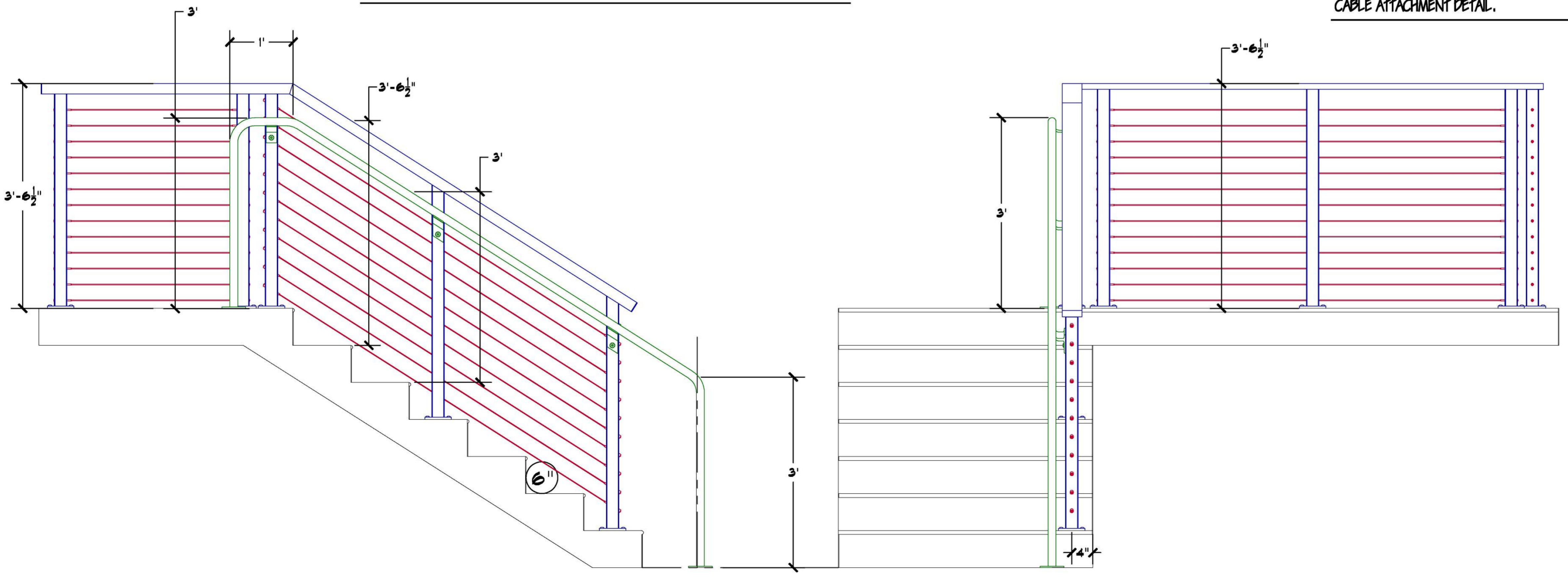

API-2000 42" STAIR GUARD RAILING.

SCALE: 1" = 1'

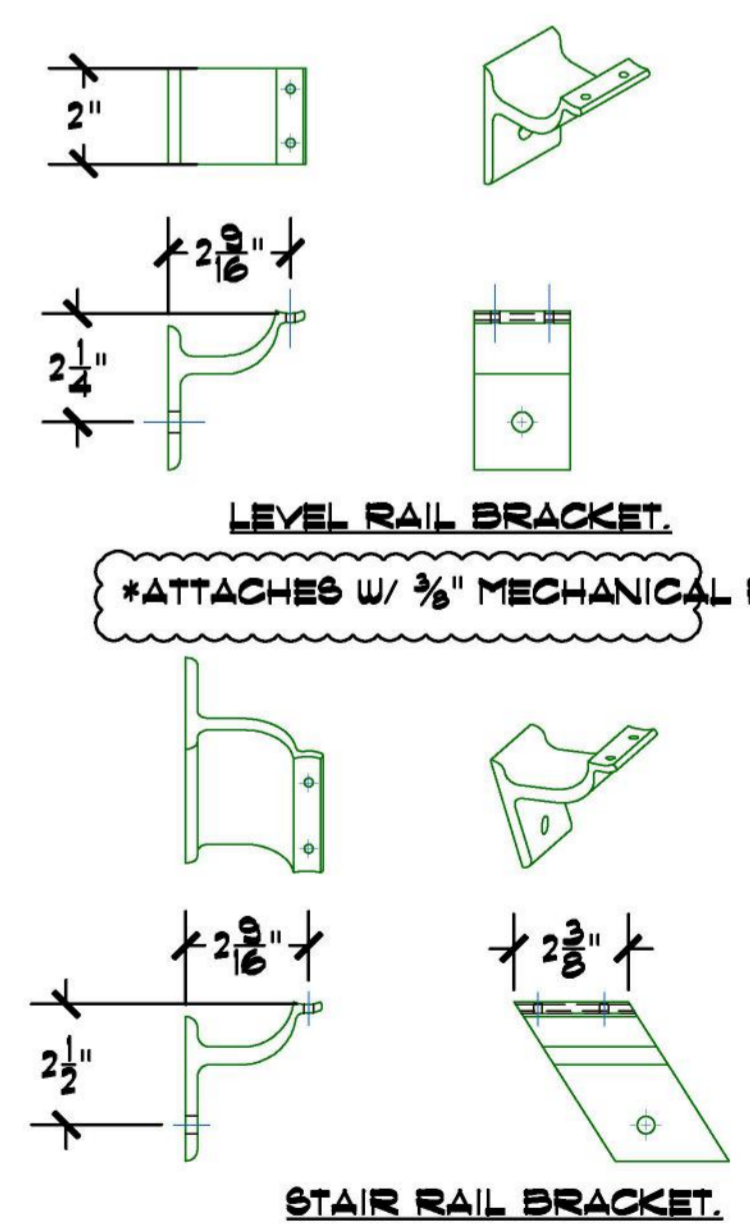

GRAB RAIL BRACKET DETAIL.

SCALE: 3" = 1'

PRODUCT: API-2000 ALUMINUM AND STAINLESS STEEL CABLE RAILING SYSTEM.
CONTENT: STANDARD SYSTEM DETAILS.
DRAWN BY: C.W.
DATE: 01-12-2015

PROPRIETARY AND CONFIDENTIAL: THE INFORMATION CONTAINED IN THIS DRAWING IS THE SOLE PROPERTY OF BECO SOUTH INC. ANY REPRODUCTION IN PART OR AS A WHOLE SALES@BECOSOUTH.COM WITHOUT THE WRITTEN PERMISSION OF BECO SOUTH INC. IS PROHIBITED.

2111 34TH WAY
 LARGO FL 33771
 PH: 727-536-1824
 FAX: 727-536-6314

